

ZONES	
Blue zone	Purple zone
Accident & Emergency	Agile Office
Shops	Bereavement Service (Swan centre)
Ward 1	Breast Screening
Ward 2	Chapel
Orange zone	Clinical Skills
Ambulatory Care	Colposcopy
Cardiac Diagnostics	Dental Department
Cardio Catheter Lab	Ear Nose & Throat
Cashiers Office	Facilities
Discharge Lounge	Gymnasium
Endoscopy	Hearing Aid Clinic
Fracture Clinic	Macmillan Swan Centre
Medical Physics	MRI Scanner
Medical Records	Orthotics
Outpatients	Physiotherapy
PALS (Patient liaison service)	Restaurant
Pharmacy	Staff Library
Procedure Investigation Unit (PIU)	Swan Centre
Radiology (X-ray & CT scanning)	Ward 4
Security	
Theatres	
Ultrasound	
Urology	Yellow zone
WRVS shop	Coffee shop
X-ray	Pre Surgical Assessment
Red zone	Surgery Centre
Bowel Screening	Wards 26 & 27
Cardiology (Ward 8)	
Chemotherapy (Ward 10)	Green zone
Critical Care Department	Chapel of rest/Mortuary
Ward 9	Day Hospital
Wards 11 & 12	Fertility Unit
Wards 14 & 14A	Occupational Health
	Ward 21
External Buildings	Wards 22 & 23
Cragside	Wards 24 & 25
Elmwood (St Bedes)	
Elmwood (Finance Dept)	Children's Unit
Maternity	Children's Outpatients
Pathology	Children's Ward (Ward 20)
Tranwell Unit (Sunnyside Ward)	
Trust HQ & Education Centre	
Women's Health Clinic	

# CAR PARKING AT THE QE HOSPITAL

## We know that hospital sites can be tiring

We don't want you to have to walk any longer than is necessary for you to get to where you need to be. You might find it easiest to park in the following places:

### Car Park 1 for...

- Main Entrance
- Outpatients (including fracture clinic)
- Children's outpatients (opposite main outpatients)
- X-Ray/Ultrasound/CT/Radiology
- Breast screening and MRI scanning (car park 1 or 2)
- Accident and Emergency
- Emergency Care Unit
- Emergency Care Assessment Unit
- Children's short stat unit/outpatients
- Ambulatory Care
- Frailty – Ward 1
- Short stay – Ward 2

### Car Park 2 for...

- Maternity and Women's Health
- Physiotherapy
- Ear, nose, throat and audiology
- Bowel screening
- Breast screening and MRI Scanning (car park 1 or 2)
- Trust HQ
- Ward 4

### Car Park 3

(Very limited space)

- Tranwell Unit
- Cragside

### Very limited parking outside Jubilee for these departments. Use car park 1 as alternative:

- Peter Smith Surgery Centre
- Jubilee Wing (including wards 21 and 22)
- Jubilee Day Hospital/DEXA Scanner
- Critical Care
- Cardiology
- Chemotherapy
- Gateshead Fertility Unit



@QEGateshead

# Queen Elizabeth Hospital

## Level 3

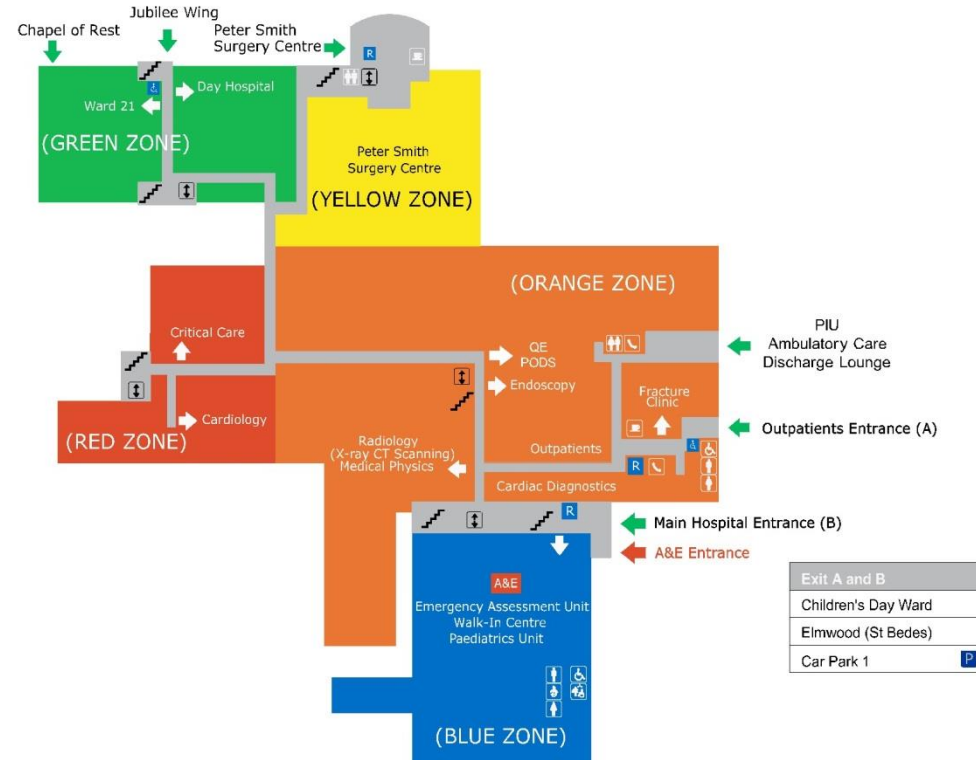

Exit A and B
Children's Day Ward
Elmwood (St Bedes)
Car Park 1

## Level 2

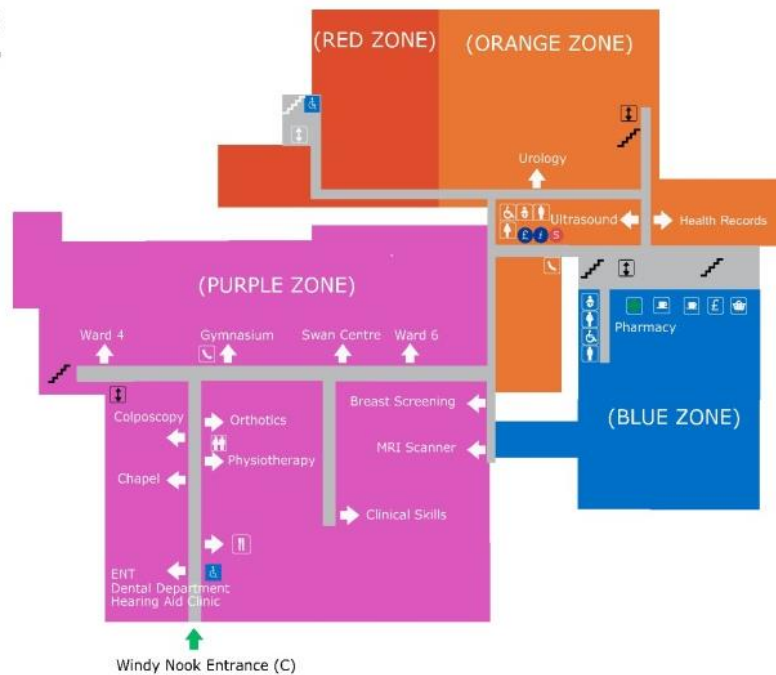

Exit C
Cragside Unit
Education Centre
Maternity
Tranwell Unit
Pathology
Trust Headquarters
Women's Health
Car Park 2
Gynaecology

Ward/Department	Level	Ward/Department	Level
Accident & Emergency	A&E 3	Medical physics	3
Ambulatory Care	3	MRI Scanner	2
Bereavement Service (Swan Centre)	2	Occupational health	2
Breast Screening	2	Orthotics	3
Cafe - Costa	2	Outpatients Department (OPD)	3
Cafe - Subway	2	PALS (patients liaison service)	2
Cafe - WRVS	3	Pathology	B
Cafe - Coffee Shop	3	Pharmacy	2
Cardiac Diagnostics (ECG)	3	Procedure Investigation Unit	3
Cardiology (Ward 8)	3	QE Pods	3
Car park 1	P	A/B Radiology (X-ray & CT scanning)	3
Car Park 2	P	C Restaurant - Quenellies	2
Cashiers Office	2	Rheumatology	3
Chapel	2	Security	2
Chapel of Rest/Mortuary	2	Surgery Centre (Peter Smith)	3
Chemotherapy Day Unit (Ward 10)	4	Swan Centre	2
Childrens Day Ward	A/B	Shop-Amigos	2
Clinical Skills	3	Tranwell Unit	C
Colposcopy	2	Trust headquarters	C
Cragside unit	C	Ultrasound	2
Critical Care Department (CCD)	3	Urology	2
Day Hospital Jubilee Wing	3	Walk-in Centre	3
Dental Department	2	Wards 1 & 2	4
Discharge lounge	3	Ward 4	2
Ear Nose & Throat (ENT)	2	Ward 6	2
Education Centre	C	Ward 8 (cardiology)	3
Elmwood - St Bedes	A/B	Ward 9	4
Emergency Assessment Unit (EAU)	3	Ward 10 (Chemotherapy Day Unit)	4
Endoscopy	3	Wards 11 & 12	5
Fertility Unit	6	Wards 14 & 14A	6
Fracture Clinic	3	Ward 21 - Jubilee Wing	3
Gymnasium	2	Wards 22 & 23 - Jubilee Wing	4
Gynaecological Oncology Centre	C	Wards 24 & 25 - Jubilee Wing	5
Health Records	2	Ward 26 - Surgery Centre	4
Hearing Aid Clinic	2	Ward 27 - Surgery Centre	5
Macmillan cancer support (swan centre)	2	Womans Health Clinic	C
Maternity Department	C	X - ray Department	3

- You Are Here
- Coloured Zone and Floor Level
- Separate Building not in this Complex
- Public Access Corridors
- Main Entrance
- Department Entrance
- Stairs
- Lift
- Reception
- Security
- Information (PALS)
- Public Wheelchairs
- Patient & Visitor Car Parking
- Public Male Toilets
- Public Female Toilets
- Public Unisex Toilets
- Disabled Toilets
- Baby Changing
- Changing Places
- Public Telephone
- Cafe
- Restaurant
- Newsagent
- Cash Machine

Disclaimer: The products and services advertised herein should not be regarded as comprising the Trust's recommendations.